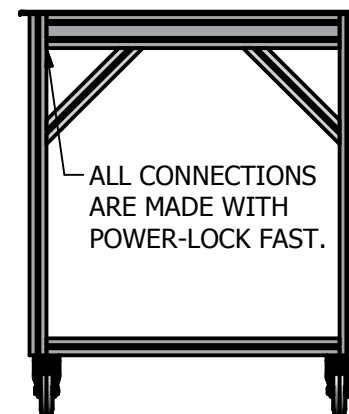
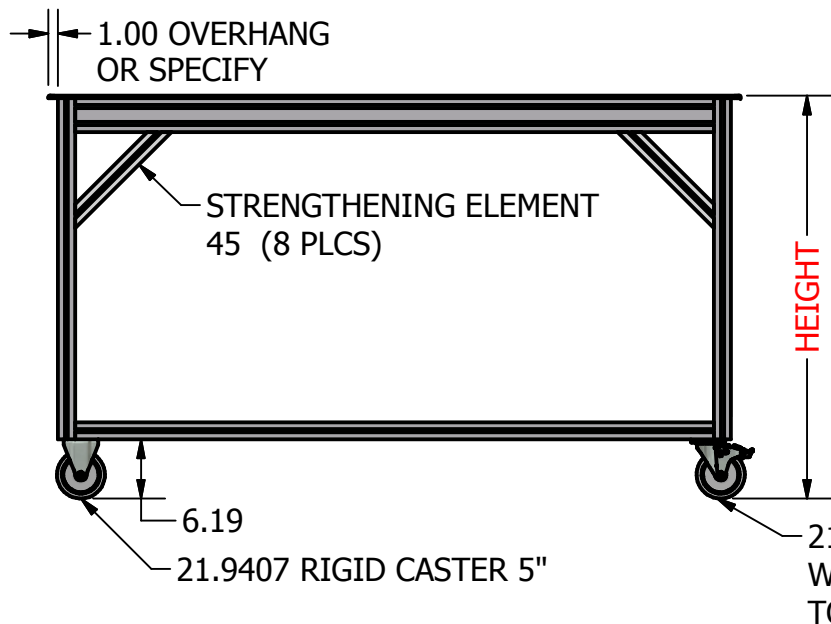
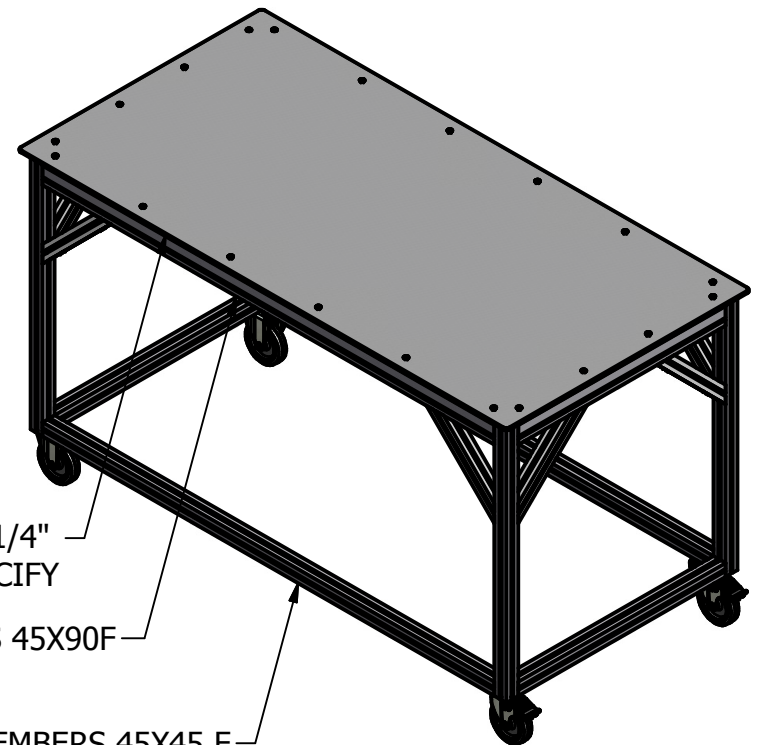

TABLE TOP 1/4"
ALUMINUM OR SPECIFY

UPPER MEMBERS 45X90F

LOWER MEMBERS 45X45 F



LOAD RATING DEPENDS ON SIZE & TYPE OF USE. THIS DESIGN IS GENERALLY FOR THE 400 - 1000 POUND RANGE

MiniTec
THE ART OF SIMPLICITY
WWW.MINITECFRAMING.COM
VICTOR, NY
PH # 585 924-4690
DIRECT 585 398-1240 EXT 104
FX # 585 924-4821
amoles@minitecframing.com

TITLE MEDIUM-HEAVY DUTY TABLE	DWG NO SP050313	REV
----------------------------------	---------------------------	-----

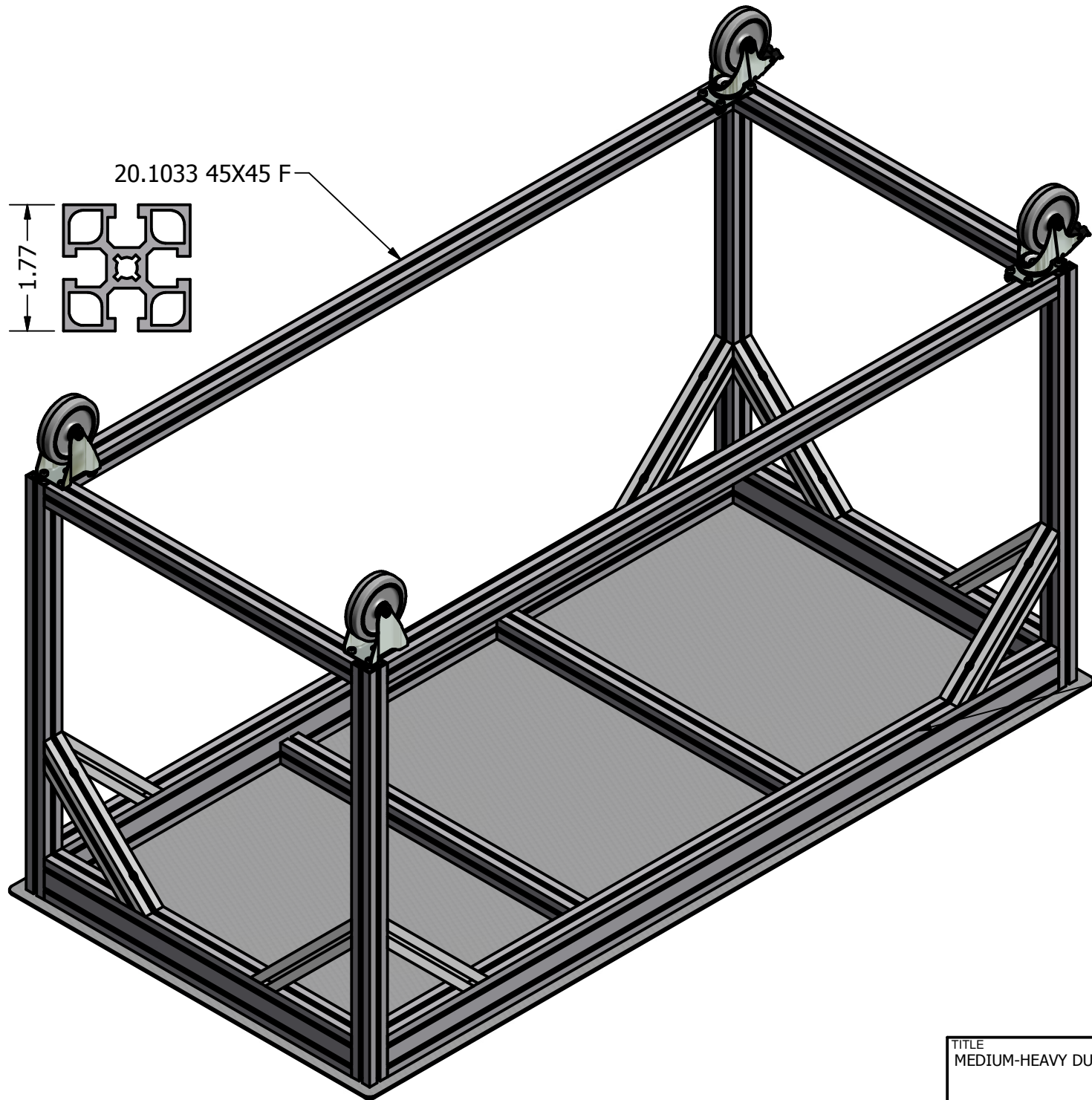

20.1033 45X45 F

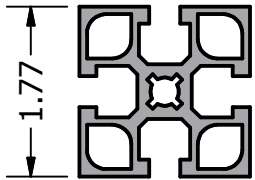

20.1032 45X90 F

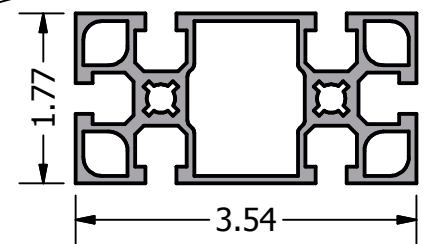

MiniTec
 THE ART OF SIMPLICITY
 WWW.MINITECFRAMING.COM
 VICTOR, NY
 PH # 585 924-4690
 DIRECT 585 398-1240 EXT 104
 FX # 585 924-4821
 amoles@minitecframing.com

TITLE MEDIUM-HEAVY DUTY TABLE	DWG NO SP050313	REV
----------------------------------	---------------------------	-----

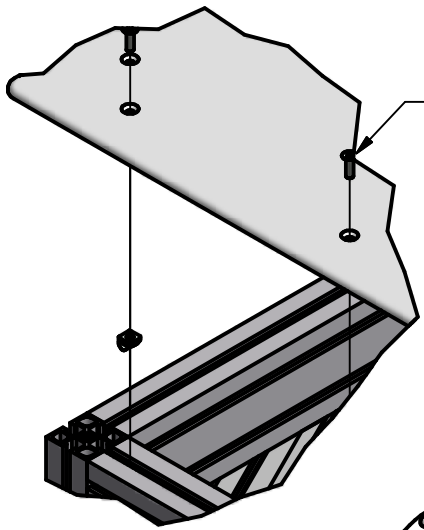

M6 C'SUNK SCREW ZINC
PLATED RECOMMENDED FOR
ALUMINUM TOPS

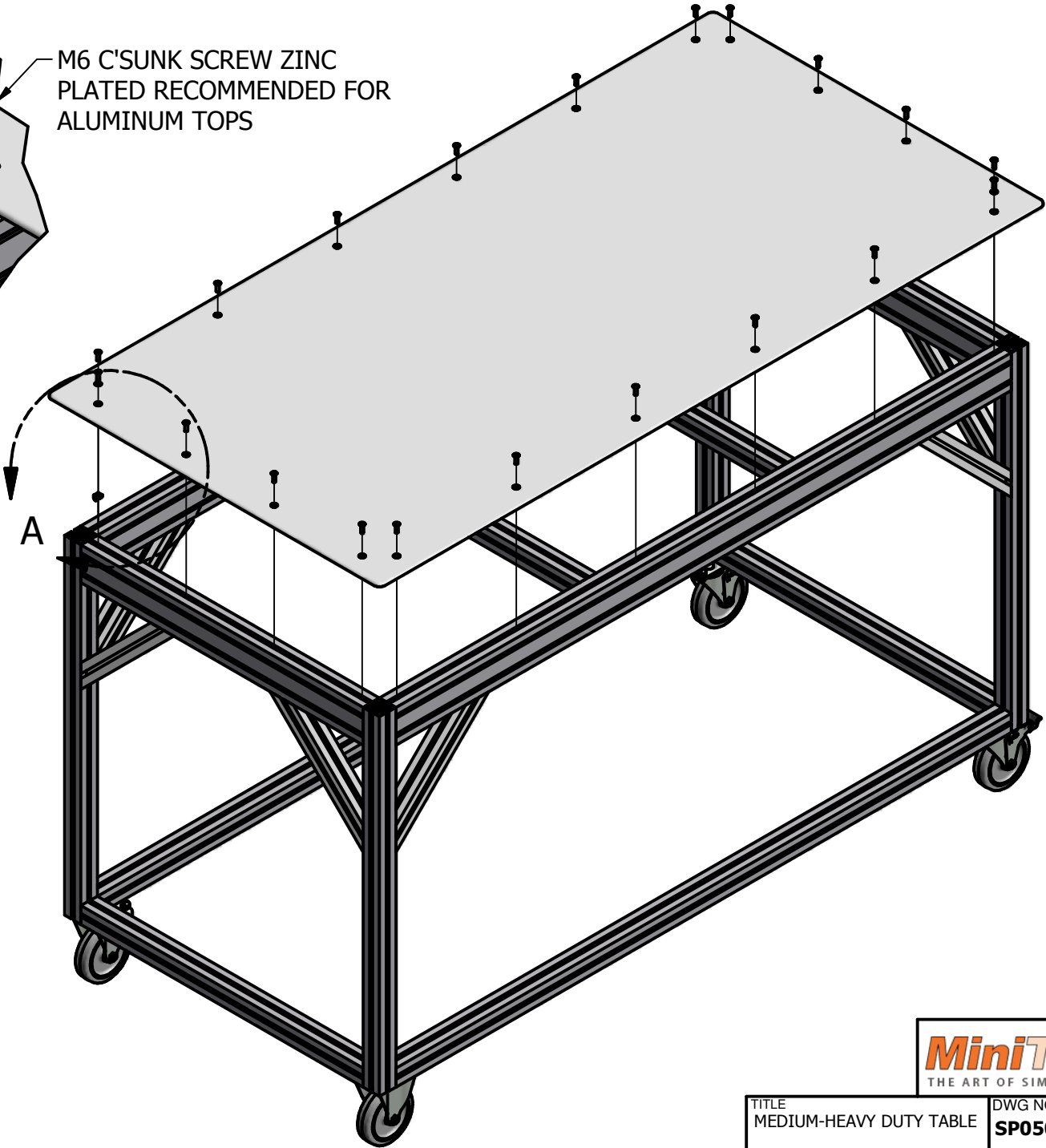

WWW.MINITECFRAMING.COM
VICTOR, NY
PH # 585 924-4690
DIRECT 585 398-1240 EXT 104
FX # 585 924-4821
amoles@minitecframing.com

MiniTec
THE ART OF SIMPLICITY

TITLE MEDIUM-HEAVY DUTY TABLE	DWG NO SP050313	REV
----------------------------------	---------------------------	-----

EXAMPLE TABLE TOP FOR 36" DEEP X 72" WIDE TABLE WITH 1" OVERHANG

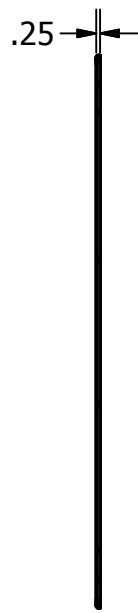
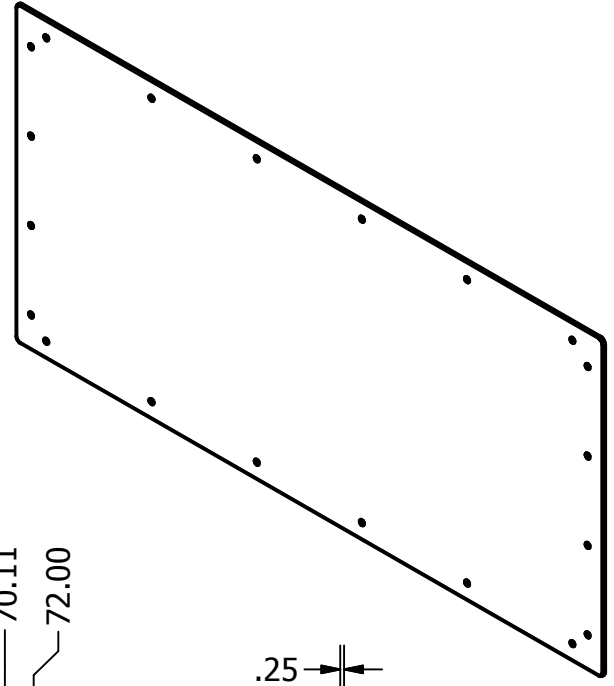
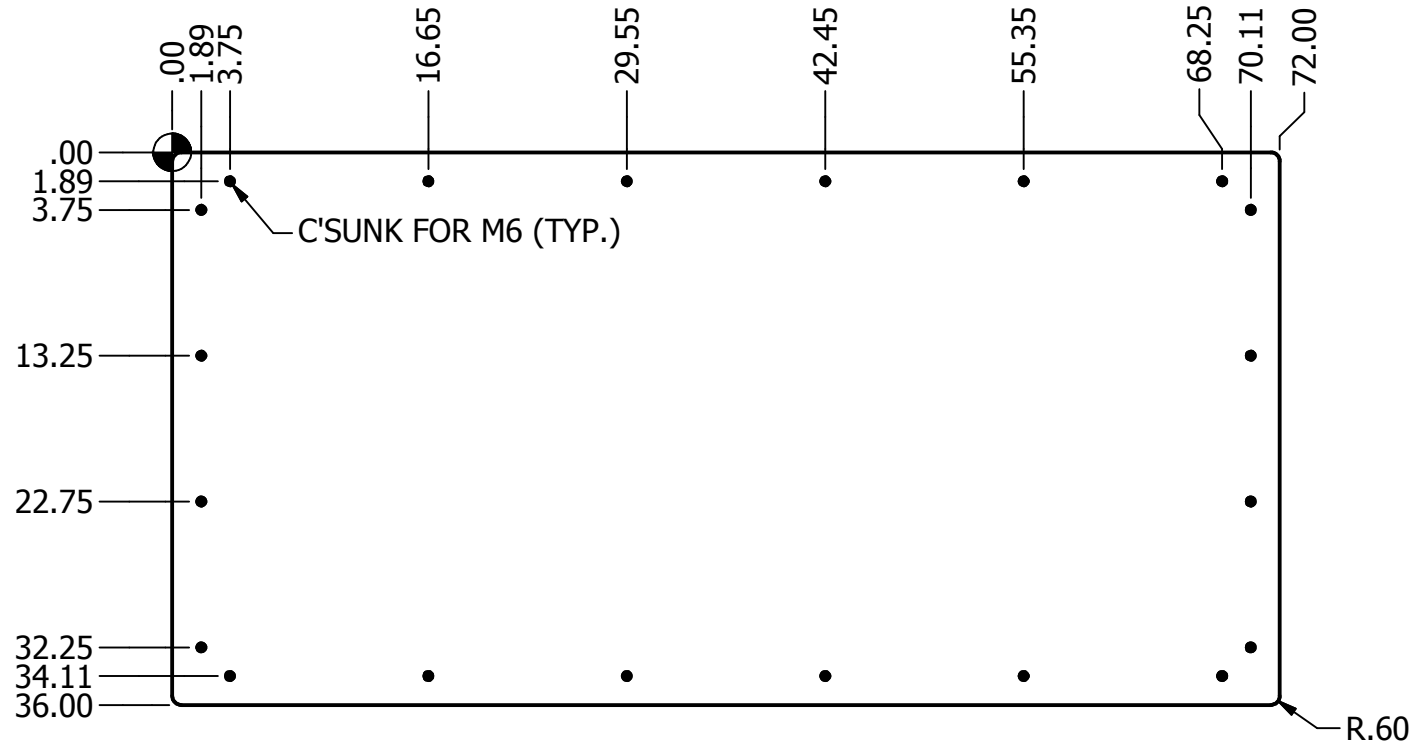

MiniTec
 THE ART OF SIMPLICITY
 WWW.MINITECFRAMING.COM
 VICTOR, NY
 PH # 585 924-4690
 DIRECT 585 398-1240 EXT 104
 FX # 585 924-4821
 amoles@minitecframing.com

TITLE MEDIUM-HEAVY DUTY TABLE	DWG NO SP050313 TABLE TOP	REV
----------------------------------	-------------------------------------	-----